

SERVICE

SERIAL NUMBER

Record serial numbers and date of purchase in spaces provided.

Date of Manufacture:	
Date of Purchase:	
Plow Serial Number	
Engine Serial Number:	

SUPPORT PROCEDURE

Notify your dealer immediately of any malfunction or failure of Ditch Witch equipment.

Always give model, serial number, and approximate date of equipment purchase. This information should be recorded and placed on file by owner at time of purchase.

Return damaged parts to dealer for inspection and warranty consideration.

Order genuine Ditch Witch replacement or repair parts from your authorized Ditch Witch dealer. Use of another manufacturer's parts may void warranty.

RESOURCES

Publications

Contact your Ditch Witch dealer for publications and videos covering safety, operation, service, and repair of your equipment.

Ditch Witch Training

For information about on-site, individualized training, contact your Ditch Witch dealer.

FOREWORD

This manual is an important part of your equipment. It provides safety information and operation instructions to help you use and maintain your Ditch Witch equipment.

Read this manual before using your equipment. Keep it with the equipment at all times for future reference. If you sell your equipment, be sure to give this manual to the new owner.

If you need a replacement copy, contact your Ditch Witch dealer. If you need assistance in locating a dealer, visit our website at **www.ditchwitch.com** or write to the following address:

The Charles Machine Works, Inc.
Attn: Marketing Department
PO Box 66
Perry, OK 73077-0066
USA

The descriptions and specifications in this manual are subject to change. The Charles Machine Works, Inc. reserves the right to improve equipment. Some product improvements may have taken place after this manual was published. For the latest information on Ditch Witch equipment, see your Ditch Witch dealer.

Thank you for buying and using Ditch Witch equipment.

**Operator's Manual
100sx**

Issue No.4.1/OP-2/07
Part Number 054-406

Copyright 1998, 1999, 2007
by The Charles Machine Works, Inc.,
Perry, Oklahoma



**Ditch
Witch**

, Ditch Witch, CMW, AutoCrowd, Modularmatic, Jet Trac, Roto Witch, Subsite, Fluid Miser, Perma-Soil, Power Pipe, Super Witch, Super Witch II, Pierce Arrow, The Underground, and The Underground Authority Worldwide are registered trademarks of The Charles Machine Works, Inc.

CONTENTS

SERVICE	1
Serial Number	1
Support Procedure	2
Resources	2
FOREWORD	3
CONTENTS	5
OVERVIEW	7
CONTROLS	9
Overview	9
Descriptions	10
SAFETY	13
Accessories	14
Underground Hazards	14
Emergency Procedures	15
Jobsite Classifications	18
Safety Alert Classifications	22
Safety Alerts	23

OPERATION	21
Inspect Machine	21
Start-up	22
Shutdown	23
Drive	24
Attach and Remove Blade	25
Plow	26
TRANSPORTATION	27
Lift	27
Haul	28
Load	29
Unload	30
LUBRICATION	31
Overview	32
Hydraulic Oil	33
Chain	33
Engine Oil	34
Wheel Bearings	35
MAINTENANCE	37
Overview	38
Tires and Lugnuts	39
Air Filter Elements	39
Belt Tension	40
SPECIFICATIONS	41

OVERVIEW

The 100SX is a self-propelled, walk-along vibratory plow. The 100SX is powered by a 10 hp (8.2 kw) Honda engine and is designed to operate in a variety of soil conditions with either a pull or feed blade.

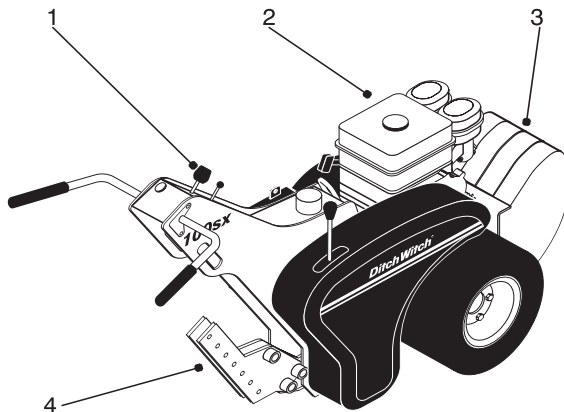

om0384h.eps

1. Control panel/operator position
2. Engine
3. Weight assembly
4. Blade mount bracket

CONTROLS

OVERVIEW

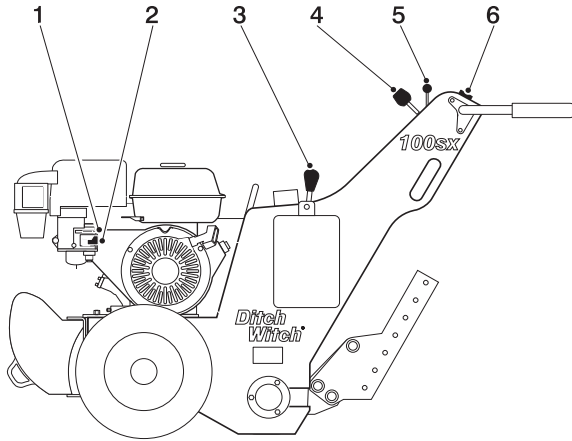

om0374h.eps

1. Choke
2. Fuel shutoff valve
3. Plow control
4. Speed/direction control
5. Throttle lever
6. Key switch

CONTROL DESCRIPTIONS

Choke

This control assists in starting cold engine.

- Push lever forward before starting.
- Pull lever back after engine is running.

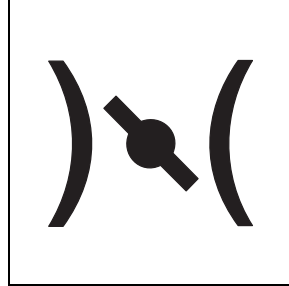

Fuel Shutoff Valve

Controls fuel flow to engine.

- Open to run machine.
- Close when machine is not running.

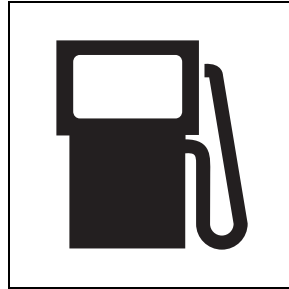

Plow Control

This lever engages and disengages plow vibrator drive.

- Push forward to engage plow vibrator.
- Pull backward to disengage plow vibrator.

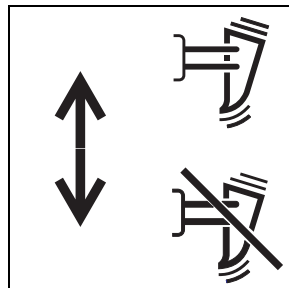

Speed/Direction Control

This lever controls the speed and direction of the ground drive.

- To travel forward, move lever to forward position.
- To travel in reverse, move lever to reverse position. Control automatically returns to neutral position if released in reverse position.
- To go faster in either direction, move control farther from neutral.
- Move control to neutral position to stop movement.

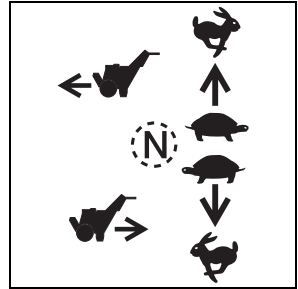

Throttle Lever

This lever controls engine and vibrator speed when plow is engaged.

- Move lever forward to increase speed.
- Move lever backward to decrease speed.

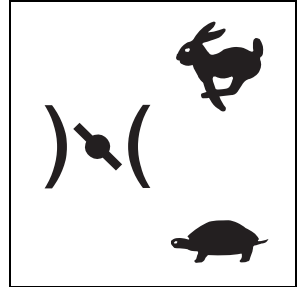

Key Switch

This switch enables engine start.

- Ensure plow control is disengaged.
- Move speed/direction control to neutral position.
- Insert key and turn to on position to enable rope start.
- Turn key to off position to stop engine.

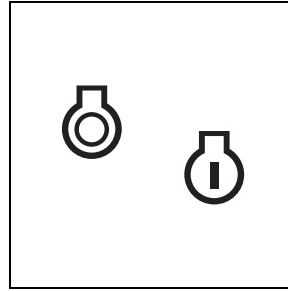

SAFETY

Follow these guidelines before operating any jobsite equipment:

- Complete proper training and read operator's manual before using equipment.
- Contact One-Call (811) and any utility companies. Have all underground lines and cables located and marked before operating equipment. If you damage a utility, contact utility company.
- Classify jobsite based on its hazards and use correct equipment, safety equipment, and work methods for jobsite.
- Mark jobsite clearly and keep spectators away.
- Wear personal protective equipment.
- Review jobsite hazards, safety and emergency procedures, and individual responsibilities with all personnel before work begins. Safety videos are available from your Ditch Witch dealer.
- Replace missing or damaged safety shields and safety signs.
- Use equipment carefully. Stop operation and investigate anything that does not look or feel right.
- Do not operate unit where flammable gas is present.
- Contact your Ditch Witch dealer if you have any question about operation, maintenance, or equipment use.

UNDERGROUND HAZARDS

Striking underground hazards can cause explosion, electrocution, fire, and exposure to hazardous materials.

Hazards include:

- Electric cables
- Natural gas lines
- Fiber optic lines
- Water lines
- Sewer lines
- Pipes carrying other chemicals, liquids, or gases
- Storage tanks

EMERGENCY PROCEDURES

If an Electric Line is Damaged

1. DO NOT MOVE. Stay where you are and do not touch any equipment.
2. Warn others that an electric line has been hit and that they should stay away.
3. Have someone contact electric company.
4. Do not return to area until given permission by electric company.

If a Gas Line is Damaged

1. Immediately shut off engine and remove any ignition sources.
2. LEAVE AREA as quickly as possible.
3. Warn others that a gas line has been hit and that they should leave the area.
4. Contact emergency personnel.
5. Contact gas company.
6. Do not return to area until given permission by gas company.

If a Fiber Optic Cable is Damaged

Do not look into cut ends of fiber optic or unidentified cable. Vision damage can occur.

SAFETY ALERT CLASSIFICATIONS

These classifications and the icons defined on the following pages work together to alert you to situations which could be harmful to you, jobsite bystanders or your equipment. When you see these words and icons in the book or on the machine, carefully read and follow all instructions. **YOUR SAFETY IS AT STAKE.**

Watch for the three safety alert levels: **DANGER**, **WARNING** and **CAUTION**. Learn what each level means.



DANGER indicates an imminently hazardous situation which, if not avoided, will result in death or serious injury.



WARNING indicates a potentially hazardous situation which, if not avoided, could result in death or serious injury.



CAUTION indicates a potentially hazardous situation which, if not avoided, may result in minor or moderate injury.

Watch for two other words: **NOTICE** and **IMPORTANT**.

NOTICE can keep you from doing something that might damage the machine or someone's property. It can also to alert against unsafe practices.

IMPORTANT can help you do a better job or make your job easier in some way.

SAFETY ALERTS

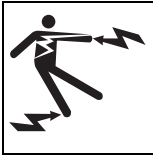

⚠ DANGER

Electric shock. Contacting electric lines will cause death or serious injury. Know location of lines and stay away.

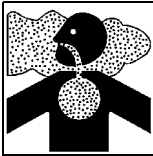

⚠ DANGER

Deadly gases. Lack of oxygen or presence of gas will cause sickness or death. Provide ventilation.

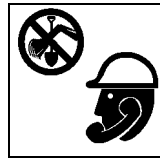

⚠ WARNING

Jobsite hazards could cause death or serious injury. Use correct equipment and work methods. Use and maintain proper safety equipment.



⚠ WARNING

Crushing weight could cause death or serious injury. Use proper procedures and equipment or stay away.



⚠ WARNING

Moving parts could cut off hand or foot. Stay away.

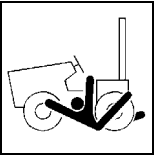
**⚠ WARNING**

Runaway possible. Machine could run over you or others. Learn how to use all controls. Start and operate only from operator's position.

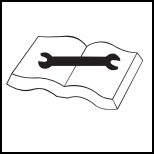
**⚠ WARNING**

Improper control function could cause death or serious injury. If control does not work as described in instructions, stop machine and have it serviced.

**⚠ WARNING**

Incorrect procedures could result in death, injury, or property damage. Learn to use equipment correctly.

NOTICES:

- Unless otherwise instructed, all service should be performed with engine shut off.
- Refer to engine manufacturer's manual for engine maintenance instructions.

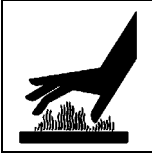

⚠ CAUTION

Hot parts may cause burns. Do not touch until cool.



⚠ CAUTION

Exposure to high noise levels may cause hearing loss. Wear hearing protection.

OPERATION

INSPECT MACHINE

Check the following before each day's work. Refer to **LUBRICATION** and **MAINTENANCE** for additional information.

- General appearance.
- Condition of plow blade, drive belts, and air filter.
- Fuel lines and fittings for signs of leakage, wear, or other damage.
- Tire pressure. Use reliable tire pressure gauge.
- Engine oil level. Keep oil level at highest line on filler cap/dipstick.
- Fuel level. Fill tank at end of day to reduce condensation.
- Signs are in place and readable.
- Guards and shields are in place.
- Nuts and bolts are tight. Tighten as specified in torque tables in *Parts Manual*.

START-UP

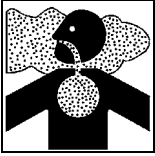
**⚠ DANGER**

Deadly gases. Lack of oxygen or presence of gas will cause sickness or death. Provide ventilation.

**⚠ WARNING**

Incorrect procedures could result in death, injury, or property damage. Learn to use equipment correctly.

IMPORTANT: Read engine manufacturer's starting and operating instructions. Follow directions for new engine break-in.

1. Disengage plow control by moving lever back.
2. Open fuel shutoff valve.
3. Check that speed/direction control (orange) is in neutral position.
4. Move throttle to half open.
5. Close choke to start cold engine.
6. Insert key into switch and turn to on position.

7. Pull briskly on starter-rope handle at left side of machine.

If engine does not start after three pulls on rope start, turn key switch to off position and check for fuel blockage or ignition system problems.

8. Check controls for correct operation.
9. After engine has warmed up, return choke to open position.

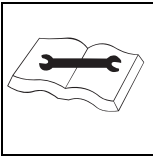
**⚠ WARNING**

Improper control function could cause death or serious injury. If control does not work as described in instructions, stop machine and have it serviced.

EMERGENCY SHUTDOWN: Turn key switch to off position.

SHUTDOWN

1. Move speed/direction control to neutral position.
2. Disengage plow drive by moving plow control lever back.
3. Turn key switch to off position and remove key.
4. Close fuel shutoff valve.

DRIVE

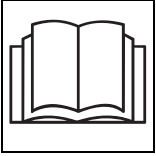
**⚠ WARNING**

Incorrect procedures could result in death, injury, or property damage. Learn to use equipment correctly.

NOTICE: Drive slowly and cautiously at all times.

**⚠ WARNING**

Jobsite hazards could cause death or serious injury. Use correct equipment and work methods. Use and maintain proper safety equipment.

1. Start with speed/direction control in neutral position.
2. Run engine with throttle at low idle.
3. Slowly engage speed/direction control.
4. Adjust drive speed with speed/direction control.
5. To stop, move speed/direction control to neutral position.

ATTACH AND REMOVE BLADE

1. Shut off engine, close fuel shutoff valve, and tip machine forward onto weight assembly.
2. Use two blade pins to position blade mounts onto vibrator arm.
3. When attaching blade mount to vibrator arm, pin top hole first. Pivot blade mount to align lower vibrator arm hole with one of lower blade mount holes. Outer hole gives more vertical angle for normal plowing. Hole nearer plow gives steeper blade angle for difficult soil conditions.
4. The plow blade can be adjusted up or down in blade mount. Always install blade pin in lowest hole possible.
5. To remove blade, remove pins holding blade mount to vibrator arm.

PLOW

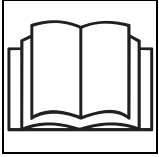
**⚠ WARNING**

Incorrect procedures could result in death, injury, or property damage. Learn to use equipment correctly.

NOTICE: Keep hands on handlebars while operating plow.

1. Drive to starting point.
2. Follow blade attachment procedure.
3. Feed cable in cable chute or insert material in pulling grip.
4. Open fuel shutoff valve.
5. Tilt machine back onto blade.
6. Start engine and run at high idle.
7. Engage plow control.
8. Lower plow blade to desired depth by pushing down on handlebars until skid-plate touches ground.
9. Slowly move speed/direction control forward to begin plowing.
10. To turn, push down on handlebars to break traction and pivot machine. Concentrate weight on handlebar to outside of turn.
11. When finished plowing, return speed/direction control to neutral position, lift handlebars to clear blade from ground, disengage plow control, and and move throttle to low idle.
12. Follow shutdown procedure.
13. Remove cable from cable chute and follow blade removal procedure.

TRANSPORTATION

**WARNING**

Crushing weight could cause death or serious injury. Use proper procedures and equipment or stay away.

LIFT

Points

Lifting points are identified by lifting decals. Lifting at any other point is unsafe and can damage machinery.

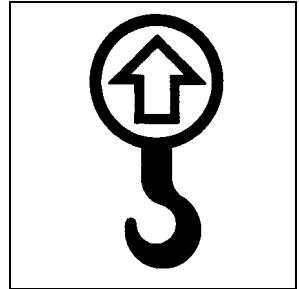

Procedure

Before lifting, check **SPECIFICATIONS**. Use a crane capable of supporting the equipment's size and weight.

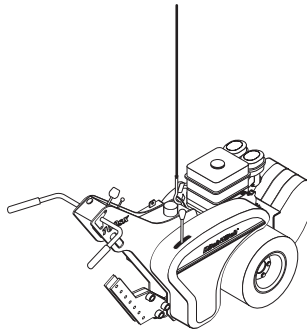

HAUL

Machine can be hauled by trailer, van, or pickup truck. Before hauling check the following:

- Check that loading ramps will support weight. See **SPECIFICATIONS**.
- Check that adequate tiedowns are available.

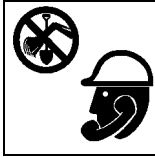
**⚠ WARNING**

Jobsite hazards could cause death or serious injury. Use correct equipment and work methods. Use and maintain proper safety equipment.

NOTICES:

- Park, unload, and load trailer on level part of jobsite.
- To prevent tipping, connect trailer to tow vehicle before loading or unloading.

LOAD

1. Follow blade removal procedure.
2. Start machine following instructions in **OPERATION**.
3. Move throttle to half open.

EMERGENCY SHUTDOWN: Turn ignition switch to off position.

4. Align machine with ramps or trailer, boom first.
5. Guide machine onto trailer.
6. When tie-down position is reached, move speed/direction control to neutral position.
7. Chain through loop on weight assembly and tightly attach chain tie-down points on bed of trailer or vehicle.

For machines with serial numbers below 4R0376, chain across weight assembly.
8. Move speed/direction control to reverse position.
9. Reverse machine to tighten front chain.
10. Follow shutdown procedure in **OPERATION**.
11. Place chain through slots below control console, attach chain to tie-down points on bed of trailer or vehicle and tighten chain with binder.

UNLOAD

1. Remove tiedowns from machine.
2. Start machine following instructions in **OPERATION**.
3. Use speed/direction control to slowly back machine off trailer or down ramps.

LUBRICATION

Proper lubrication and maintenance protects Ditch Witch equipment from damage and failure. In extreme conditions, lubricate more frequently.

Use only recommended lubricants. Fill to capacities listed in **SPECIFICATIONS** section.

Recommended Lubricants	
GEO	Gasoline engine oil (see oil temperature chart for appropriate SAE weight) meeting API engine service classification SD
MPG	Multipurpose grease
THF	Tractor hydraulic fluid, similar to Phillips 66 HG, Mobilfluid 423, Chevron Tractor Hydraulic Fluid, Texaco TDH Oil, or equivalent
CL	Chain lubricant

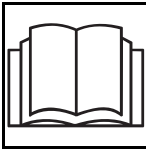

sf1027

⚠ WARNING

Incorrect procedures could result in death, injury, or property damage. Learn to use equipment correctly.

NOTICES:

- Unless otherwise instructed, all service should be performed with engine off.
- Refer to engine manufacturer's manual for engine maintenance instructions.

OVERVIEW

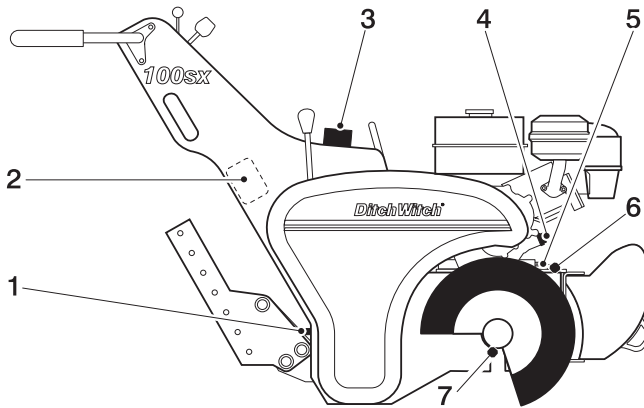

om0372h.eps

Interval	Task	Ref.	Lubricant
10 hours	Check hydraulic oil	3	THF
	Check engine oil	4	GEO
25 hours	Lube chain	6	CL
50 hours	Change engine oil	4,5	GEO
150 hours	Change hydraulic oil and filter	1,2,3	THF
	Lube wheel bearings	7	MPG

HYDRAULIC OIL

Check

Check hydraulic oil at filler/breather cap every 10 hours. Oil level should be at bottom of strainer screen when cool. Add THF if needed.

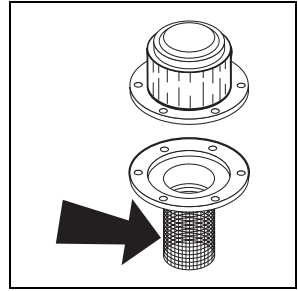

Change

Change hydraulic oil and filter every 150 hours. Drain oil at plug (2) located behind the plow mount. Replace drain plug.

Change hydraulic oil filter (1) located above drain plug.

Fill to bottom of strainer screen with THF.

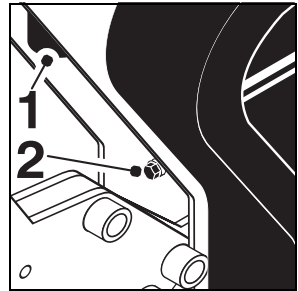

CHAIN

Lube chain every 25 hours with CL.

Access chain through hole in front of engine.

WHEEL BEARINGS

Lube zerk every 150 hours with
MPG.

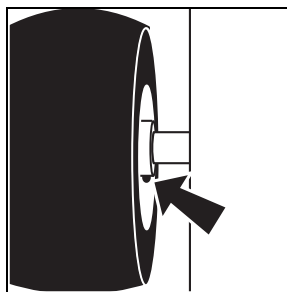

MAINTENANCE

Proper lubrication and maintenance protects Ditch Witch equipment from damage and failure. In extreme conditions, lubricate more frequently.

**WARNING**

Incorrect procedures could result in death, injury, or property damage. Learn to use equipment correctly.

NOTICES:

- Unless otherwise instructed, all service should be performed with engine shut off.
- Refer to engine manufacturer's manual for engine maintenance instructions.

OVERVIEW

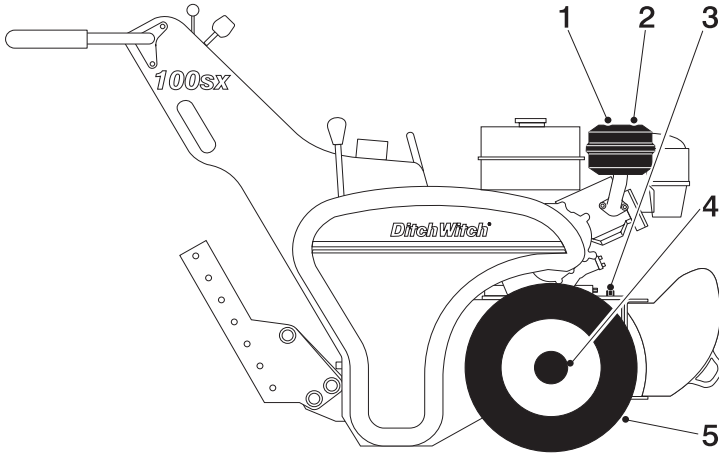

om0373h.eps

Interval	Task	Ref.
10 hours	Check tires and lugnuts	5,4
25 hours	Clean foam air filter element	2
100 hours	Change paper air filter element	1
As needed	Clean feed chute on plow blade	
	Adjust belt tension	3

TIRES AND LUGNUTS

Check tires every 10 hours for proper inflation. Use an accurate pressure gauge. Maintain air pressure at 15 psi (10.3 kPa). Tighten lugnuts to 32 ft•lb (43.2 N•m).

For machines with serial numbers below 4R0376, tighten castle nut firmly, then align castle nut slot with pin hole and insert cotter pin. If wheel will not turn without binding, loosen nut to next slot that aligns with hole. Reinstall cotter pin.

AIR FILTER ELEMENTS

Wash foam element (2) every 25 hours in high flashpoint solvent.

NOTICE: Do not use gasoline or low flashpoint solvent for cleaning. They are flammable and are explosive under certain conditions.

Change paper element (1) every 100 hours.

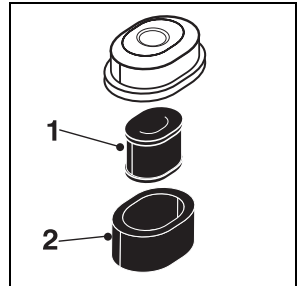

BELT TENSION

As needed, adjust belt tension by loosening four engine mounting bolts. Move engine forward to increase belt tension or backward to reduce tension.

SPECIFICATIONS

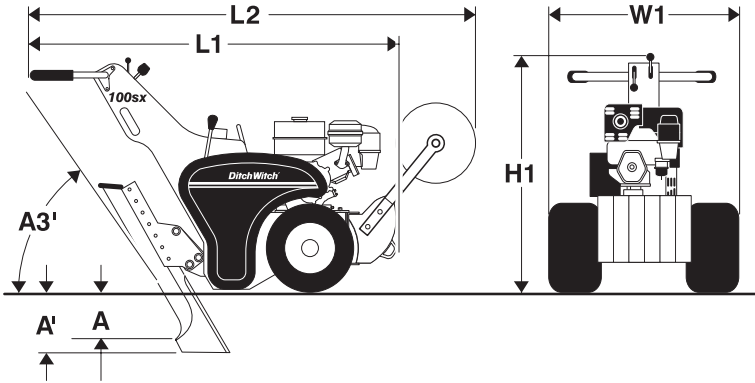

om0376h.eps

DIMENSIONS		U.S.	METRIC
H1	Operating height	41 in	104 cm
A3'	Angle of departure without blade	50°	50°
L1	Maximum length without reel carrier	70 in	178 cm
L2	Maximum length with reel carrier	86.5 in	220 cm
W1	Plow vehicle width	35 in	89 cm
A'	Maximum depth	13 in	33 cm
A	Maximum cover depth	12 in	30 cm
GENERAL			
Ditch Witch Model 100SX, self-propelled, non-riding, hydrostatic, two-wheel drive, vibratory plow. Pull and feed blades available. Ground drive is through rubber tires.			

OPERATION	U.S.	METRIC
Maximum crowd speed forward	92 fpm	28 m/min
Maximum crowd speed reverse	92 fpm	28 m/min
Vehicle clearance circle	70 in	178 cm
Plow blade sizes		
Pull blades (cover depth x mole diameter)	6-12 x .75 in	152-305 x 19 mm
Feed blades (tube diameter x cover depth (bend radius))	.375 x 6-12 (1) in	9 x 152-305 (25) mm
Operating weight	720 lb	327 kg
Operator orientation: facing front of vehicle		
Vibration	47.9 ft/s ²	14.6 m/s ²
ENGINE		
Honda GX340 gasoline engine		
Cooling medium: air		
Number of cylinders: one		
Displacement	20.6 in ³	337 cm ³
Bore	3.22 in	82 mm
Stroke	2.52 in	64 mm
Engine manufacturer's gross power rating @ 3600 rpm	11 hp	8.2 kW
*Maximum governed speed as installed (no load)	3400 rpm	3400 rpm
Flywheel power @ 3400 rpm (full load)	10.2 hp	7.5 kW
Fuel consumption @ 3600 rpm	0.89 gph	3.4 L/h
**Maximum tilt angle	20°	20°
*All warranty is void if engine is run above maximum governed speed as installed (no load)		
**Exceeding these operating angles will cause engine damage. This DOES NOT imply machine is stable to maximum angle of safe engine operation.		

POWER TRAIN	U.S.	METRIC
Transmission: Hydrostatic, infinitely variable forward and reverse, 3:1 chain drive from motor to axle		
Tires: 18 x 11-8, 3-ply		
Drive line system: belts and sheaves		
Vibratory mechanism: eccentric shaft		
HYDRAULIC SYSTEM		
Ground drive pump capacity @ 3600 rpm, relief valve setting @ 2,000 psi	2.2 gpm	8.3 L/min
Ground drive pump displacement/revolution	.223 in ³	.556 cm ³
Ground drive motor displacement/revolution	9.6 in ³	157 cm ³
Directional control valve type: open center		
Delivery capacity	10 gpm	37.8 L/min
System relief valve setting	2500 psi	17 237 kPa
FLUID CAPACITIES		
Fuel tank	1.7 gal	6.5 L
Engine oil	2.3 pt	1.1 L
Hydraulic system	3.5 gal	13.2 L

NOISE LEVELS

Operator 92 dBA sound pressure per ISO 6394

Exterior 101 dBA sound power per ISO 6393

VIBRATION LEVELS

Vibration at the operator's hand during normal operation is x m/s²

Specifications are general and subject to change without notice. If exact measurements are required, equipment should be weighed and measured. Due to selected options, delivered equipment may not necessarily match that shown.

WARRANTY

Ditch Witch Equipment and Replacement Parts North American* Limited Warranty Policy

Major Component Limited Warranty

Major components are warranted for a period of 1000 hours of use or one year, whichever occurs first, beginning on date of delivery of any such new product. The Major Component Limited Warranty covers only Major Components listed under Major Component Limited Warranty that are manufactured and distributed by The Charles Machine Works, Inc. ("CMW"). Replacement parts and other serial numbered products ("Products") that are not listed under Major Component Limited Warranty, and non-major components are covered under Product Limited Warranty.

Major Components are defined as:

- Frames.
- Differentials and parts contained within.
- Mechanical transmissions.
- Drive gearboxes and parts contained within.
- Hydraulic, hydrostatic, and fluid pumps, motors and components that control or protect pumps and motors.
- Auxiliary hydraulic control valves and electrical components used for controlling hydraulic components.
- Hydraulic cylinders and components excluding repair kits.
- Batteries, alternators, instruments, gauges, and protection components for electrical systems.
- Pierce Arrow bodies, strikers, and tailpieces.

Free replacement parts and labor will be provided at any authorized dealership for any part of Major Component which has a defect in material or workmanship within warranty period. Defects will be determined by an inspection of major component or part by CMW or its authorized dealer. The product containing a major component or part must be presented to CMW or its authorized dealer for inspection within 30 days of the date major component or part fails. CMW will provide the location of its inspection facilities or its nearest authorized dealer upon inquiry. CMW reserves the right to supply remanufactured replacement parts as it deems appropriate.

* Equipment owners in countries other than U.S., Canada, Mexico, and Puerto Rico should refer to Ditch Witch International Warranty Policy.

Product Limited Warranty

Products are warranted for 90 days from date of delivery of any new product. Free replacement parts and labor will be provided at any authorized dealership for any product which has a defect in material or workmanship within warranty period. Replacement parts are warranted for 90 days from date of delivery of any such replacement part. Any part of a product subject to ground contact is warranted only for defects in material or workmanship and only for the period of operational life of such part, which period shall not in any event exceed 90 days. Defects will be determined by an inspection of the product or part by CMW or its authorized dealer. The product or part must be presented to CMW or its authorized dealer for inspection within 30 days of the date of failure. CMW will provide the location of its inspection facilities or its nearest authorized dealer upon inquiry. CMW reserves the right to supply remanufactured replacement parts as it deems appropriate.

Exclusions

from Major Component and Product Limited Warranty

Specifically excluded from Major Component and Product Limited Warranty are:

- Transportation charges related to repair, replacement, or inspection of products, major components, or parts.
- Parts subject to ground contact (including but not limited to drill pipe, downhole tools, digging chain, teeth and sprockets).
- All incidental or consequential damages.
- All defects, damages, or injuries caused by misuse, abuse, improper installation, alteration, neglect, or uses other than those for which products were intended.
- All defects, damages, or injuries caused by improper training, operation, or servicing of products in a manner inconsistent with manufacturer's recommendations.
- All engines and engine accessories (these are covered by original manufacturer's warranty).
- Parts which may be subject to another manufacturer's warranty (such warranty will be available to purchaser).
- All implied warranties not expressly stated herein, including any warranty of fitness for a particular purpose and merchantability.

IF THE PRODUCTS ARE PURCHASED FOR COMMERCIAL PURPOSES AS DEFINED BY THE UNIFORM COMMERCIAL CODE, THEN THERE ARE NO WARRANTIES WHICH EXTEND BEYOND THE FACE HEREOF AND THERE ARE NO IMPLIED WARRANTIES OF ANY KIND WHICH EXTEND TO A COMMERCIAL BUYER. ALL OTHER PROVISIONS OF THIS LIMITED WARRANTY APPLY INCLUDING THE DUTIES IMPOSED.

Ditch Witch products have been tested to deliver acceptable performance in most conditions. This does not imply they will deliver acceptable performance in all conditions. Therefore, to assure suitability, products should be operated under anticipated working conditions prior to purchase.

This limited warranty applies to the owner of the product. Some states do not allow exclusion or limitation of incidental or consequential damages, so above limitation of exclusion may not apply. Further, some states do not allow exclusion of or limitation of how long an implied warranty lasts, so the above limitation may not apply. This limited warranty gives owner specific legal rights and the owner may also have other rights which vary from state to state.

For information regarding this limited warranty, contact CMW's Product Support department, P.O. Box 66, Perry, OK 73077-0066, or contact your local Ditch Witch dealer.

First version: 1/91; Latest revision: 4/99

**A Note To
Ditch Witch
Equipment Owners:**

If your equipment was purchased through a Ditch Witch dealer, there is no need to read further.

However, if you purchased from any other source, please fill out the form on the reverse side and return it to us.

This will enable you to receive updates on this equipment as well as information on new products of interest.

Thanks for using Ditch Witch equipment.

(Please Fold Along This Line And Seal At Bottom With Tape)



**NO POSTAGE
NECESSARY
IF MAILED
IN THE
UNITED STATES**

BUSINESS REPLY MAIL
FIRST CLASS PERMIT NO 23 PERRY OKLAHOMA

POSTAGE WILL BE PAID BY

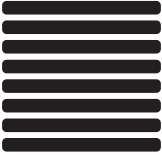

**The Charles Machine Works, Inc.
P.O. Box 66
Perry, Oklahoma 73077-9989**



Ditch Witch® Registration Card

Please Type or Print All Information

Purchaser's Company Name

Attention

Street Address or P.O. Box

City

County

State

Zip

Nation

()

Phone Number With Area Code

Model

Serial Number

Attachments/Accessories

Serial Numbers

Attachments/Accessories

Serial Numbers

Attachments/Accessories

Serial Numbers

Name of Ditch Witch Dealership

Your Signature